

- LEGEND
- COUNTY BOUNDARY
 - U.S. LAND TOWNSHIP LINE
 - SECTION LINE
 - NATIONAL FOREST BOUNDARY
 - PARK OR RESERVATION BOUNDARY
 - PAVED STATE OR U.S. HIGHWAY
 - U.S. NUMBERED HIGHWAY
 - STATE HIGHWAY
 - PAVED LOCAL ROAD
 - GRAVEL LOCAL ROAD
 - GRADED & DRAINED LOCAL ROAD
 - UNIMPROVED LOCAL ROAD
 - RAILROAD
 - RAILROAD STATION
 - GRADE CROSSING
 - OVERPASS
 - UNDERPASS
 - HIGHWAY BRIDGE (ON POST OR MARK IN LENGTH)
 - MILEAGE BETWEEN POINTS
 - PAVED FORD OR LOW WATER BRIDGE
 - LEVEE OR DIKE
 - LAKE, RESERVOIR OR POND
 - LAKE, RESERVOIR OR POND WITH DAM
 - WIDE RIVER OR STREAM
 - DOCK, PIER OR LANDING
 - SMALL STREAM
 - CORPORATE LIMITS AND ROADS THROUGH TOWN
 - COUNTY SEAT
 - OTHER CITIES AND TOWNS
 - MUNICIPAL AIRPORT
 - PRIVATE AIRFIELD
 - FARM UNIT OR DWELLING
 - GROUP OF CLOSELY SPACED DWELLINGS (IF NO FARM SHOWN)
 - CHURCH OR OTHER RELIGIOUS INSTITUTION
 - SCHOOL
 - POST OFFICE & POST OFFICE AND BUSINESS
 - CEMETERY
 - CHURCH WITH CEMETERY ADJACENT
 - BUSINESS ESTABLISHMENT
 - FACTORY OR INDUSTRIAL PLANT
 - GRAVEL PIT
 - QUARRY
 - TOWN OR COMMUNITY HALL
 - APRIL, GARAGE, OR COUNTY GARAGE
 - FIRE ENGINE HOUSE
 - POWER SUBSTATION
 - TRAILER PARK
 - HISTORICAL MONUMENT
 - CAMP OR LODGE
 - GOLF COURSE OR COUNTRY CLUB
 - WATER SUPPLY STANDPIPE OR TANK
 - CHICKEN HOUSE OR OTHER LIVESTOCK

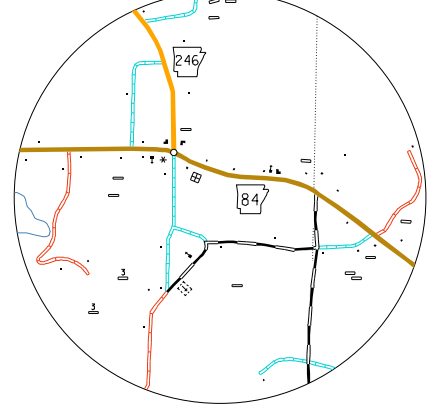

ATHENS
Sec. 14, 15, T 5 S, R 28 W

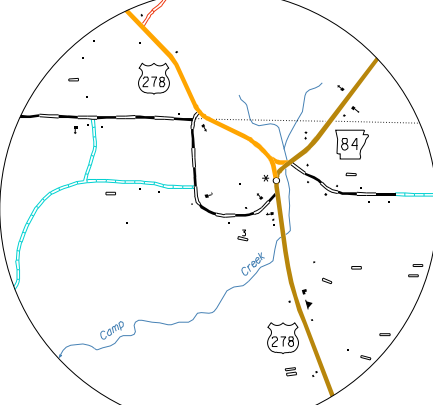

EMPIRE
Sec. 25, 36, T 5 S, R 29 W

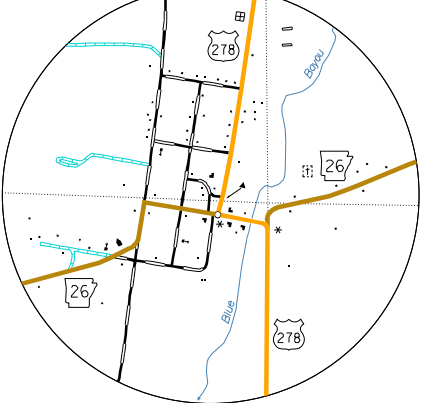

CENTER POINT
Sec. 25, 26, 35, 36, T 8 S, R 28 W

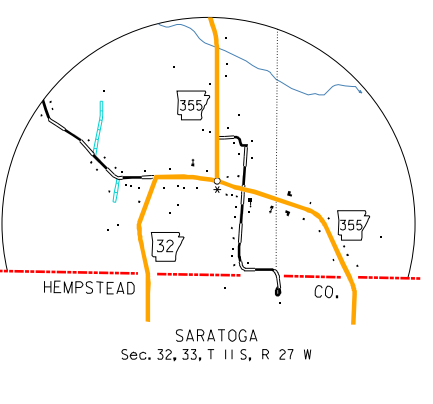

HEMPSTEAD
Sec. 32, 33, T 11 S, R 27 W

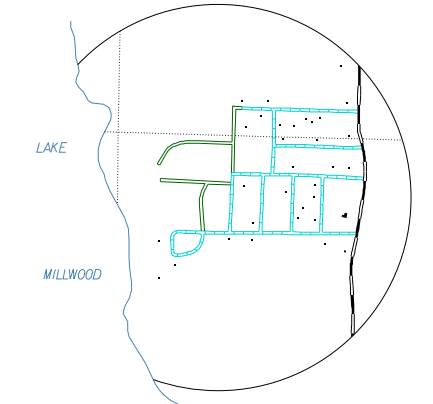

COTTON SHED
Sec. 14, 15, T 11 S, R 28 W

NOTE: Enlargements of all congested areas are five times map scale unless otherwise noted.
Individuals are available for all active incorporated cities.
Area: 595.23 Square Miles
Population: 42,000 2000 Census
Map Issued: 6-10-00; replaces map issued 4-6-99
Field Inventory 1977
Map revisions made from aerial photographs taken 2-3-98
Map completion completed 2-28-00
County map produced using Computer Assisted Cartography.
Map Revised 05-12-2009, relocation of S&W 26, Section 1 and S&W 36, Section 14, 15

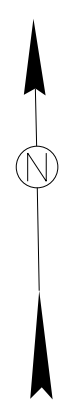

GENERAL HIGHWAY MAP
HOWARD COUNTY
ARKANSAS

PREPARED BY
ARKANSAS STATE HIGHWAY AND TRANSPORTATION DEPARTMENT
PLANNING AND RESEARCH DIVISION
IN COOPERATION WITH
U.S. DEPARTMENT OF TRANSPORTATION
FEDERAL HIGHWAY ADMINISTRATION
SCALE 1:62,500
MILES
KILOMETERS

Copies of this map are available at a nominal fee from the Arkansas State Highway and Transportation Department, P.O. Box 226-Little Rock, Ark. 72203

